



Dedicated To Excellence,  
Merchandisers, Walk-in Coolers & Freezers

Open Display – VASC Economy  
VASC 36 - Digital

Project Name: \_\_\_\_\_  
Location: \_\_\_\_\_  
Item #: \_\_\_\_\_ Qty: \_\_\_\_\_

## SPECIFICATION

### CABINET CONSTRUCTION

- The cabinet interior and exterior is 26 gauge Black or white metal.
- Metal tested to NSF splash zone requirements.
- Strong one piece body design incorporates 14 gauge G90 outer bottom.
- Cabinets are all steel construction with foamed in place, moisture impervious polyurethane insulation.

### LIGHTED SIGN

- Large lighted display area.
- Supplied with lighting white Acrylite 3mm thick Plexiglas.
- All cabinets are same sign dimension to ensure consistency when lining up multiple cabinets.

### INTERIOR LIGHTING

- Fluorescent interior lighting.
- Plastic safety shield protects bulb.
- Cool white bulbs highlight your product presentation.

### SHELVING

- Cabinets supplied with four heavy duty shelves
- NSF approved white epoxy coated shelves.
- Steel pilaster strips allow for adjustment of shelves in 1/2" increments
- Four zinc coated steel clips are supplied per shelf ( VASC 36 , VASC 48)
- Five zinc coated steel clips are supplied per shelf ( VASC 60 , VASC 72)



### DIGITAL CONTROLER

- XR 40 C Dixell temperature controller ensures accurate temperature control.
- Control also ensures correct air defrost cycles to eliminate coil icing conditions.

### CONDENSATE REMOVAL SYSTEM

- Hot gas self-contained condensate removal system ensures effective removal of water buildup from coil without the use of a drain.

© 2005 Coldstream Products Corp. All Rights Reserved.  
1001 Regent Ave. W. | Winnipeg, MB Canada | R2C 4M2  
Phone: 204.669.1201 | Toll Free: 1.800.394.1004 | Fax: 204.222.0655  
Email: [sales@coldstreamproducts.com](mailto:sales@coldstreamproducts.com)



Dedicated To Excellence,  
Merchandisers, Walk-in Coolers & Freezers

**NOTES:**

- Designed to operate in ambient temperatures and humidity that do not exceed 75 deg f and 55% relative humidity.
- Unit should not be installed near, supply air registers, exterior doorways or near heat generating equipment. Avoid installation of cabinet in direct sunlight.
- VASC cabinets designed for the storage of pre cooled products.
- For pull down requirements or more severe environments please consult the factory or refer to MVP series open style merchandisers.

**REFRIGERATION SYSTEM**

- Top mounted heavy duty refrigeration system ensures that warm air expelled from the condenser is not in contact with the cold air of the air curtain.
- Top mounted also ensures the minimum of dirt and dust build-up on
- The condenser for trouble free system operation.
- The refrigeration system meets TYPE 1 NSF approval for the storage of packaged products. See [www.nsf.com](http://www.nsf.com) for details.
- Factory engineered , capillary tube system for maximum performance and temperature control.

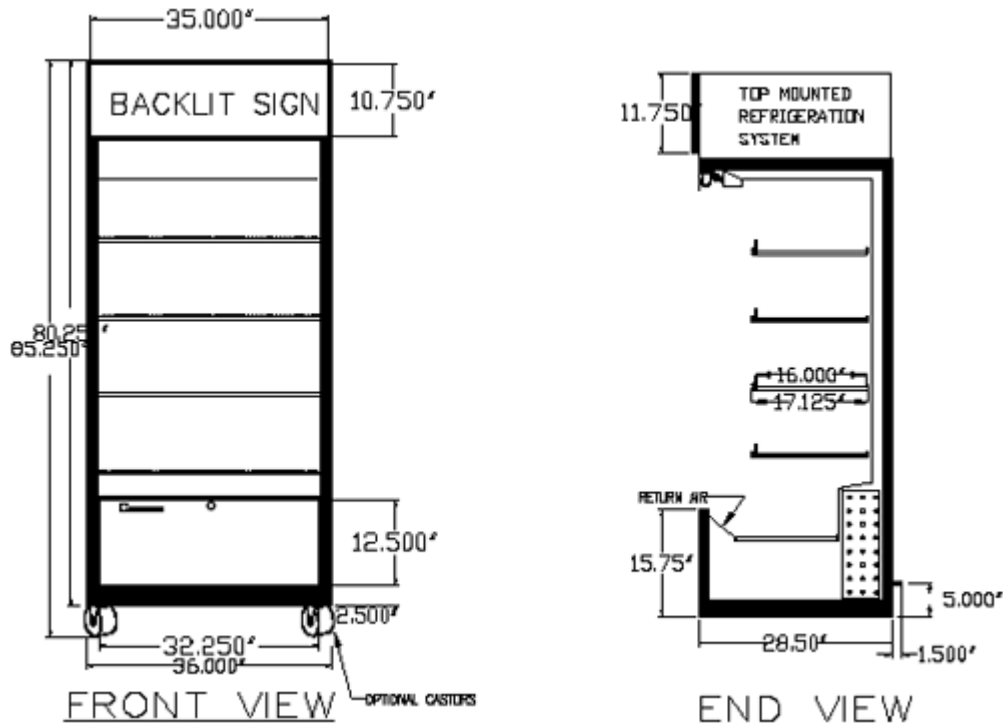



Dedicated To Excellence,  
Merchandisers, Walk-in Coolers & Freezers

## Reach-In Products

### Open Display VASC Economy

- Air Screen System –no doors to open
- Large lighted sign display area
- Unique air design provides close constant temperatures throughout the cabinet
- Polyurethane foam body for energy efficiency.
- Self condensating, no need for a drain
- Digital control for temperature defrost Cycles

### Open Display Standard Version

Model	Doors	Shelves	Width OD	Depth OD	Height OD	HP	Amps	Circuit	Voltage	Refrig	Ship Wt
VASC 36 Digital	N/A	4	36.0	28.5	80.25	3/4	21.6	30	115	R22	525



© 2005 Coldstream Products Corp. All Rights Reserved.  
 1001 Regent Ave. W. | Winnipeg, MB Canada | R2C 4M2  
 Phone: 204.669.1201 | Toll Free: 1.800.394.1004 | Fax: 204.222.0655  
 Email: [sales@coldstreamproducts.com](mailto:sales@coldstreamproducts.com)